

För håltagningsmått se blad
2, för krafter blad 3

*Panel anpassad på plats
**Specialpanel

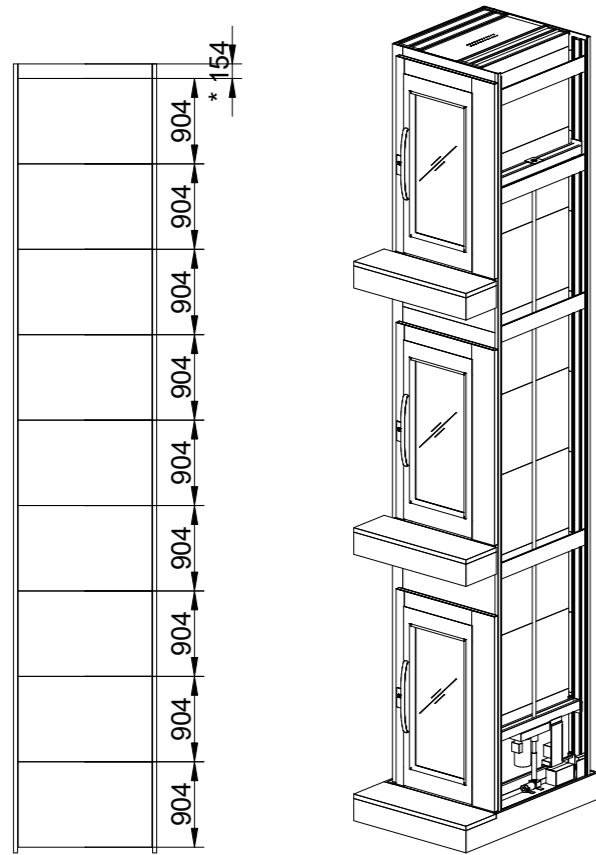

E

Placering av maskinsida:

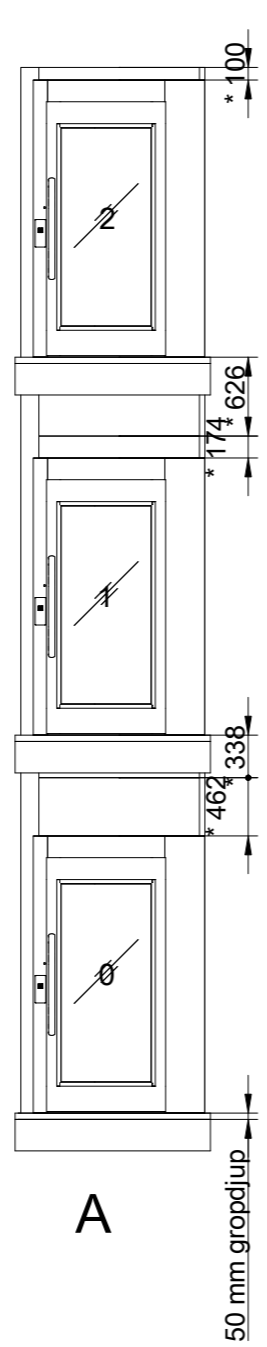
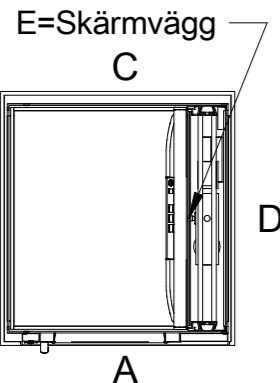

A

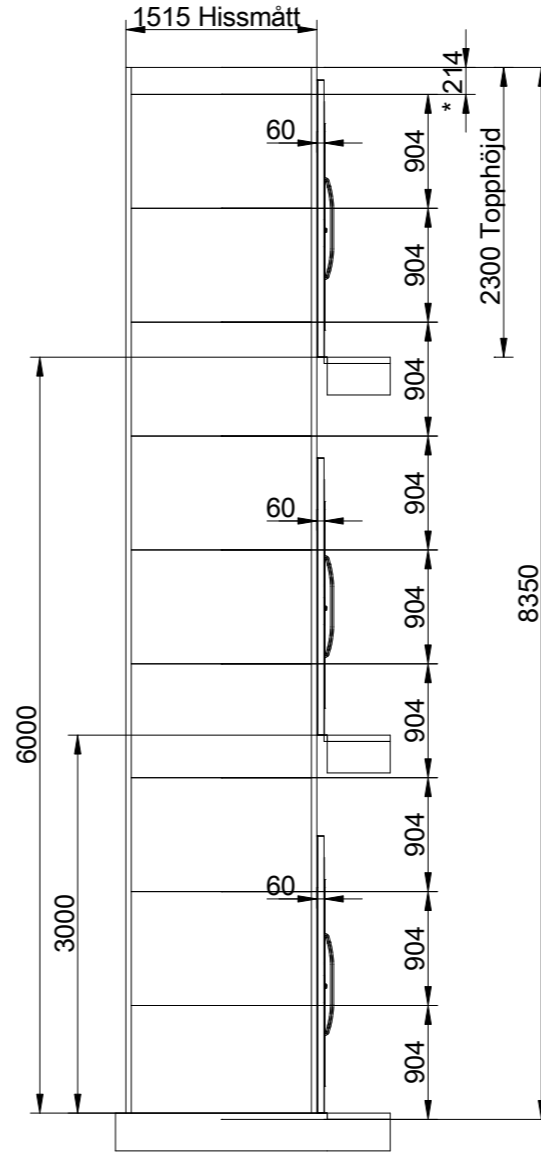

B

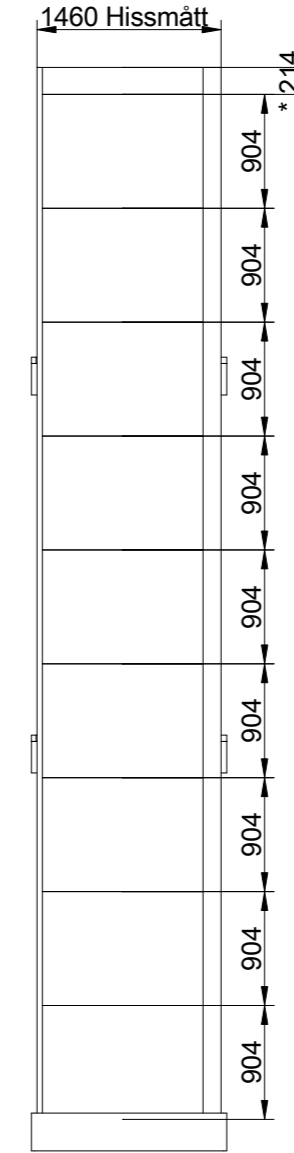

C

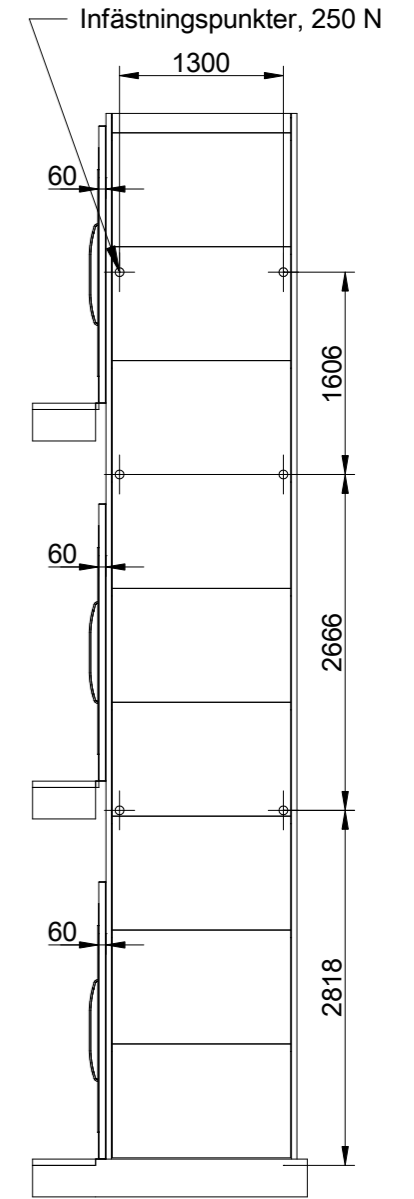

D

Teknisk specifikation
Capacity: 400 kg
4kW Freq. Conv 3 x 400 VAC

Godkänd av
byggare:

European view placement:



Offert

Order

Gen. Tolerances
SS-ISO 27681-1 m

Principritning
A 5000 - 1100*1467
Hissritning

Datum
2025-05-12
14:28

Blad
1 of 7

Skala:
A3, 1:60

Håltagningsmått för schaktet

Platsbyggt schakt

Håltagningsmått för dörrfront		
Stannplan	Bredd	Höjd
A 0	1500	2250
A 1	1500	2250
A 2	1500	2250

A1,2 (1:5)

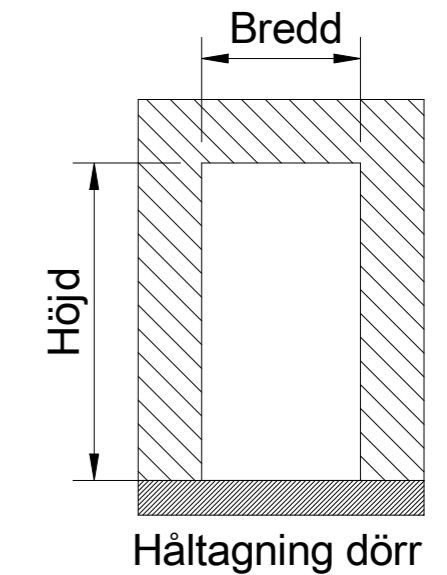
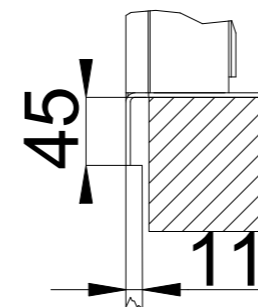

Håltagning dörr

A0 (1:5)

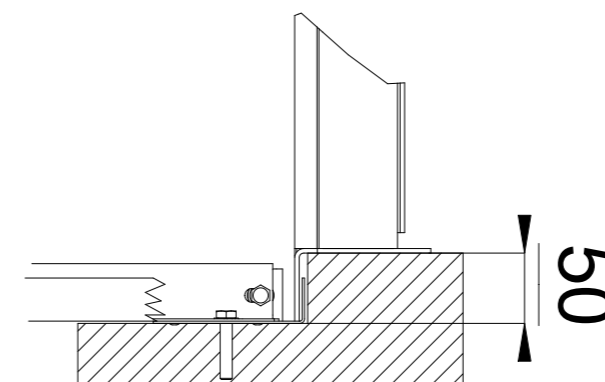

Incoming power supply is connected at landing:

For wiring and power supply, refer to the unit's wiring diagrams.
Ceiling shaft lighting, is independent from the power cable and pulled back into the trench's upper part. Shaft lighting > 50 lux.

NOTE! An effective emergency telephone is required for approved inspection.
The purchaser is responsible for an active phone line being present prior to the lift installation.

The incoming telephone line is connected to CiLow (TELE). Refer to wiring diagram.

The emergency signal device is powered by the lift's own battery in the event of a power failure.

The lift must be equipped with a two-way communication, either via the standard telephone or via the lift telephone, which automatically calls the alarm control center or the like.

NOTE! A lift featuring a frequency converter cannot be directly connected to a RCD.

NOTE! The platform lift shall be connected to a dedicated power supply conforming with EN 60204-1:2018, terminating at a main switch and fuse or overload with a means to lock it in the 'off' position or disconnected state

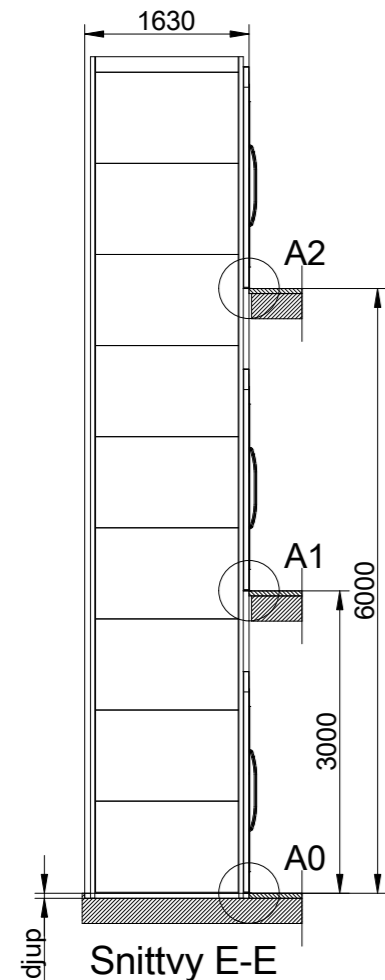

Snittvy E-E

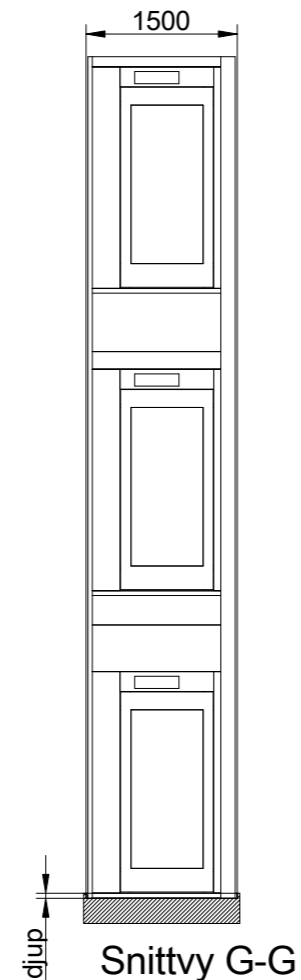

Snittvy G-G

50 mm gropdjup, gropgolvet skall vara plant + 10 mm, - 0 mm

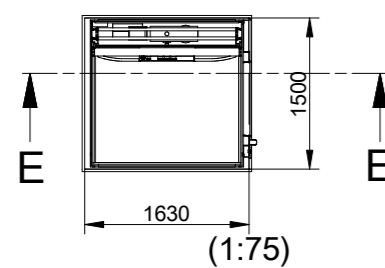

(1:75)

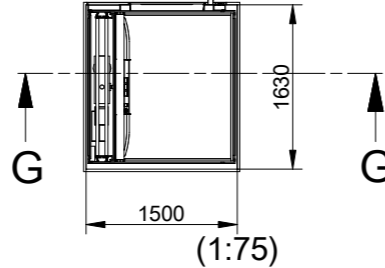

(1:75)

Godkänd av byggare:

European view placement:



Offert

Order

Gen. Tolerances

SS-ISO 27681-1 m

Principritning

A 5000 - 1100*1467

Datum

2025-05-12

Blad

2 of 7

Skala:

A3, 1:60

6 5 4 3 2 1

**Krafter på schakt och plattform
samt infästningspunkter för bottenram**

 L section force: 7.5 kN
L section load: 24.59 kN/m²
Sektion-L vikt: 750 kg

 Mast force: 8.5 kN
Mast load: 68.55 kN/m²
Vikt på gejdernpaket: 850 kg

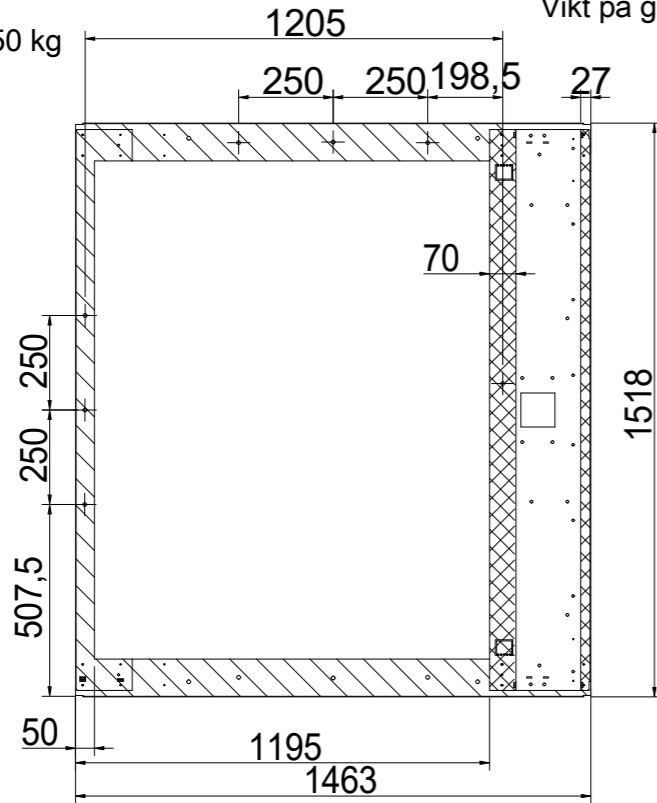

Skala: 1:20

Totalvikt på hiss(inkluderar märkläst): 1600 kg

**Rekommenderad montering av infästningspunkter.
Last per infästningspunkt, F=250 N**

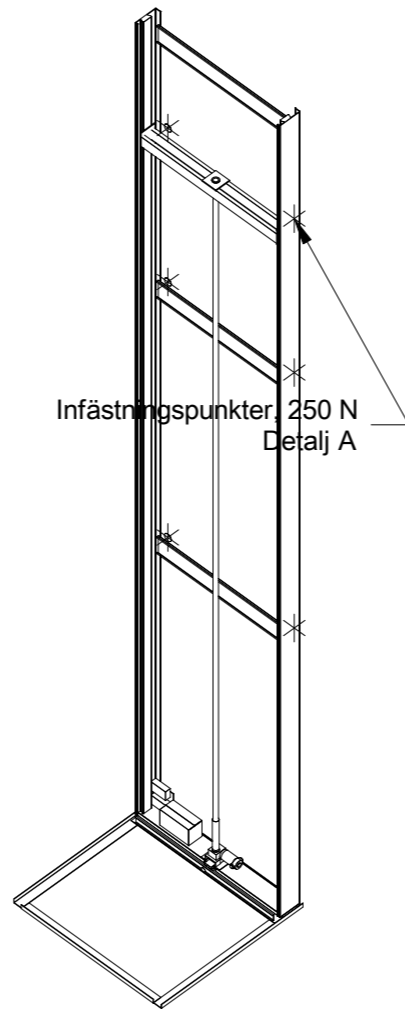

A (1:5)

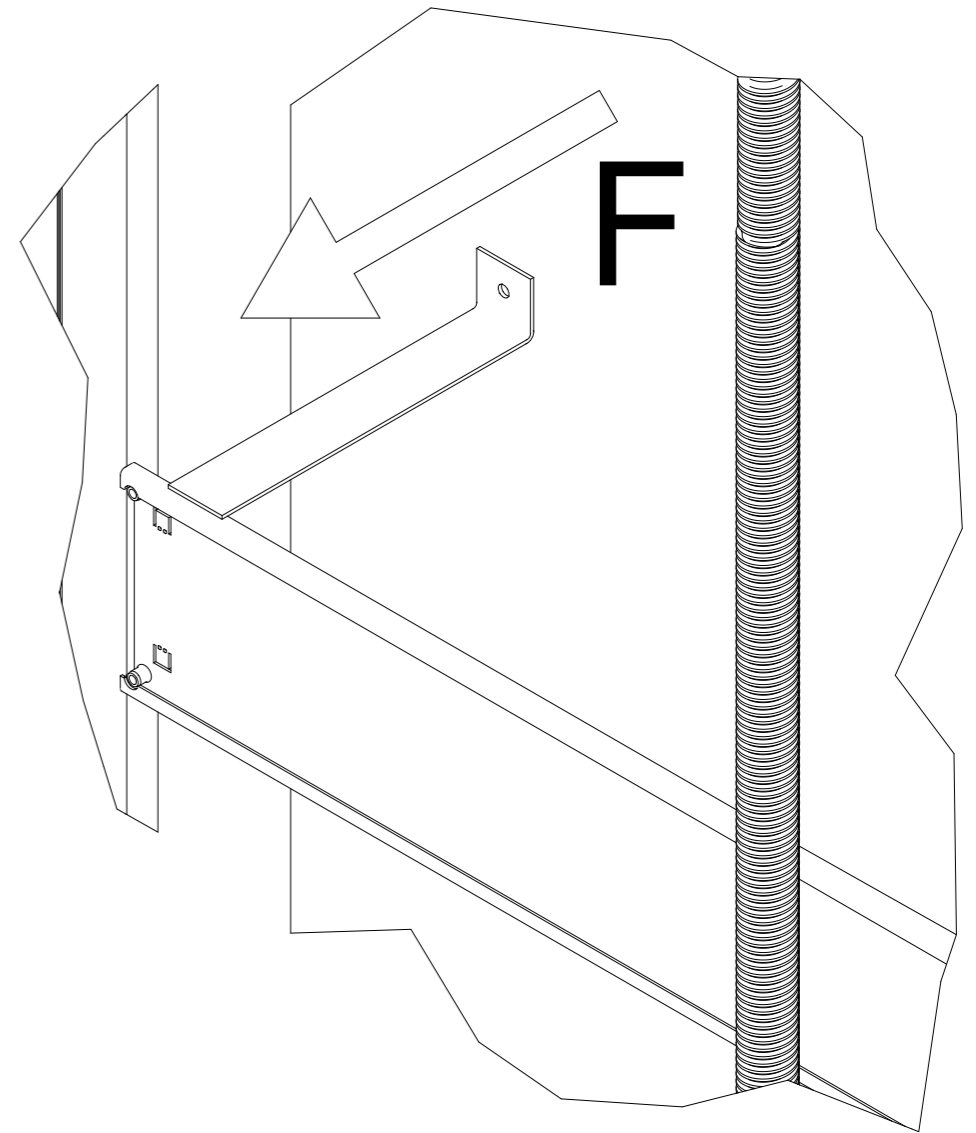

D

C

B

A

D

C

B

A

6 5 4 3 2 1

Godkänd av byggare:

European view placement:



Offert

Order

Gen. Tolerances
SS-ISO 27681-1 m

Principritning
A 5000 - 1100*1467
Loads and forces

Datum
2025-05-12
14:28

Blad
3 of 7

Skala:
A3, 1:60

Stannplan 0 och dörrfrontsinformation
Skala: 1:20

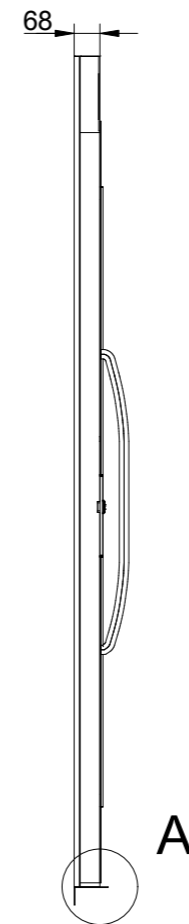
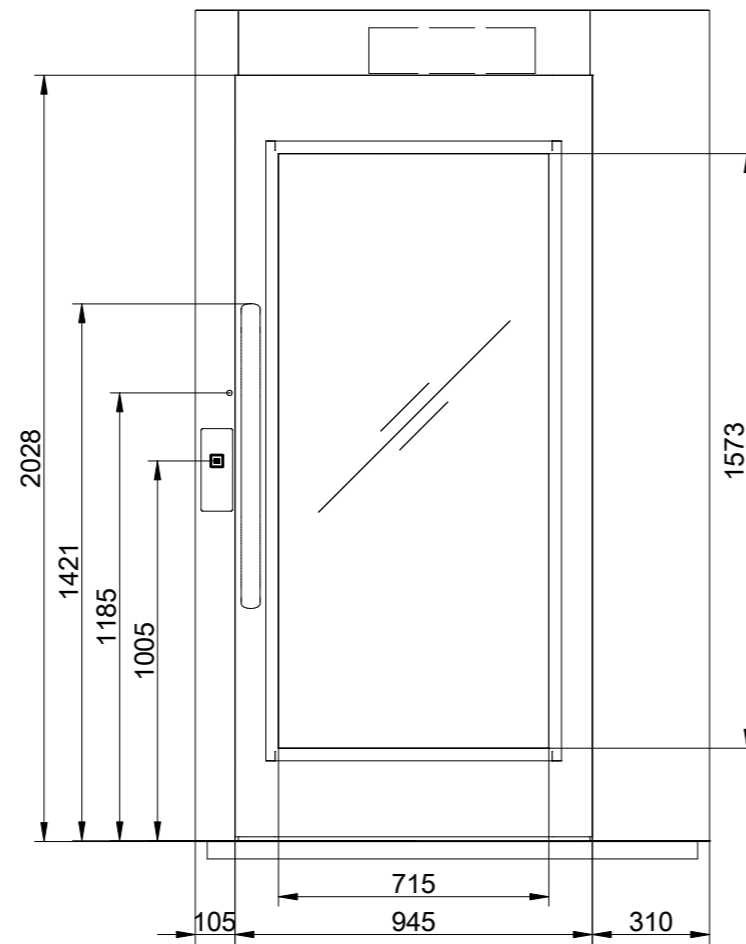
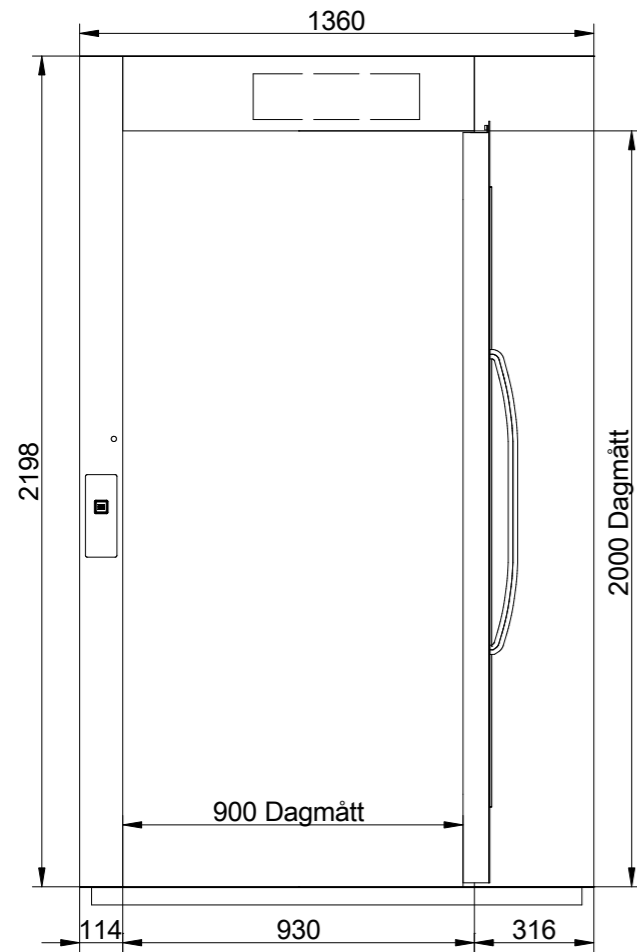

A

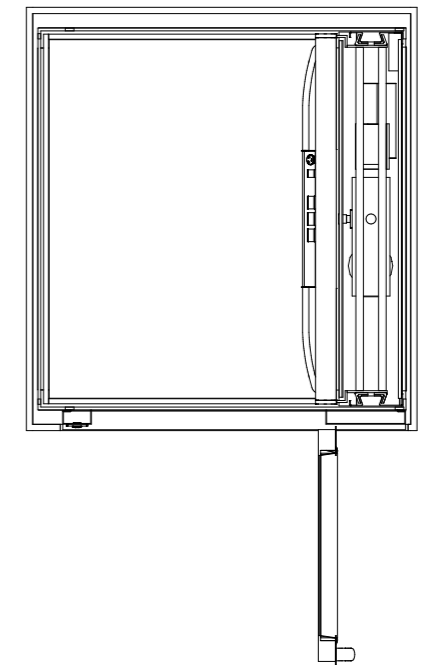

Skala: 1:30

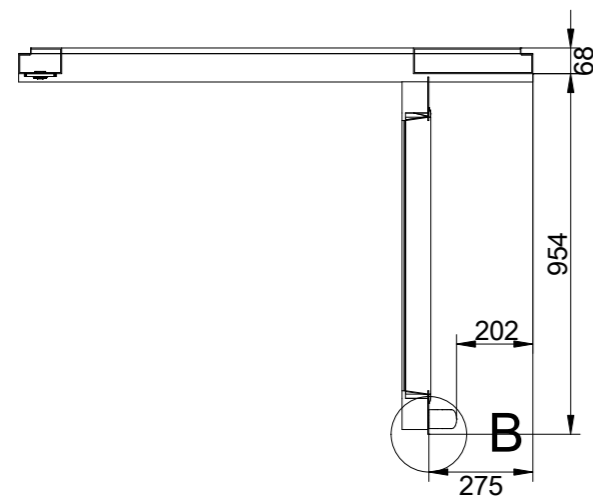

B

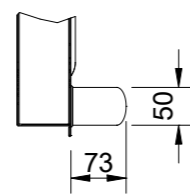

B (1:10)

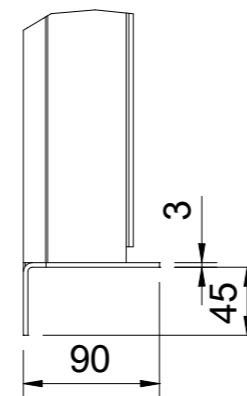

A (1:5)

Stannplan	Dörrtyp
0	A20
1	A20
2	A20

Godkänd av byggare:

European view placement:



Offert

Order

Gen. Tolerances
SS-ISO 27681-1 m

Principritning
A 5000 - 1100*1467
Landing information

Datum
2025-05-12
14:28

Blad
4 of 7

Skala:
A3, 1:60

Stannplan 1 och dörrfrontsinformation
Skala: 1:20

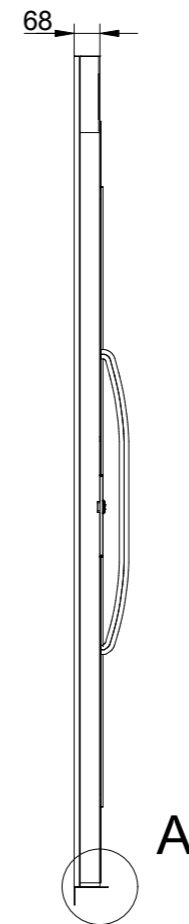
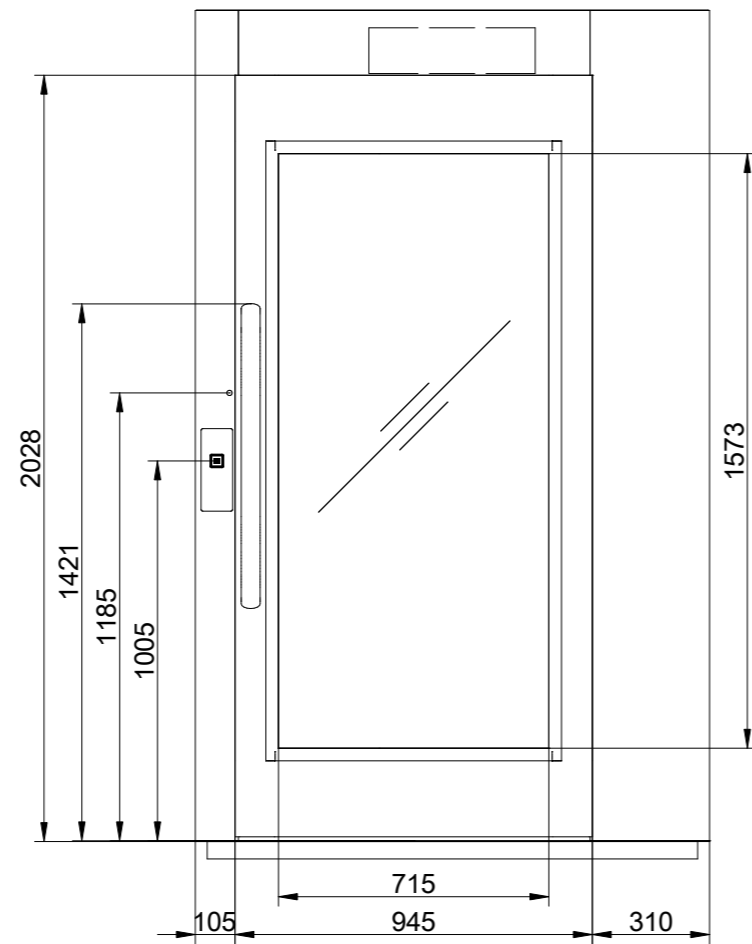
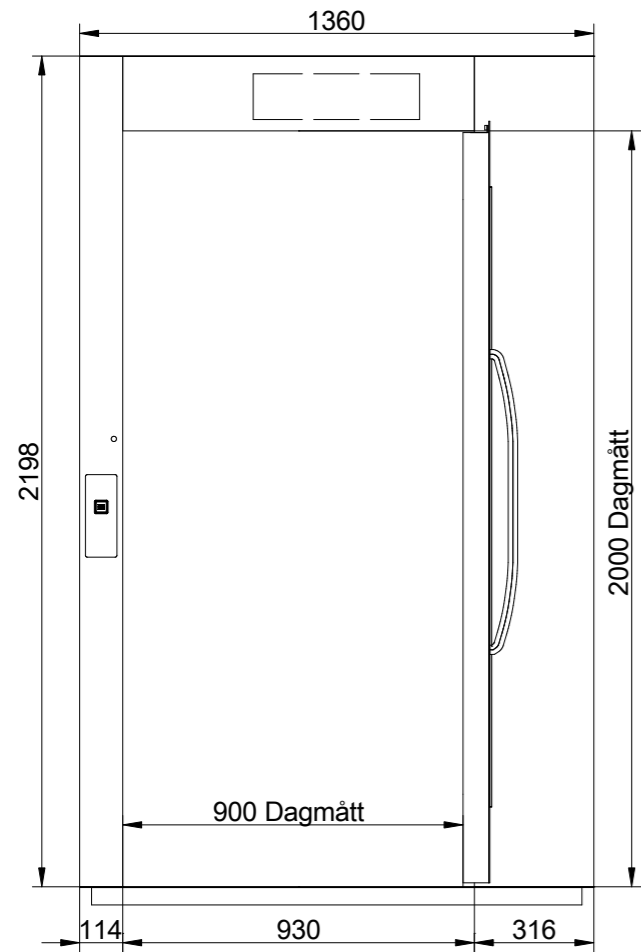

A

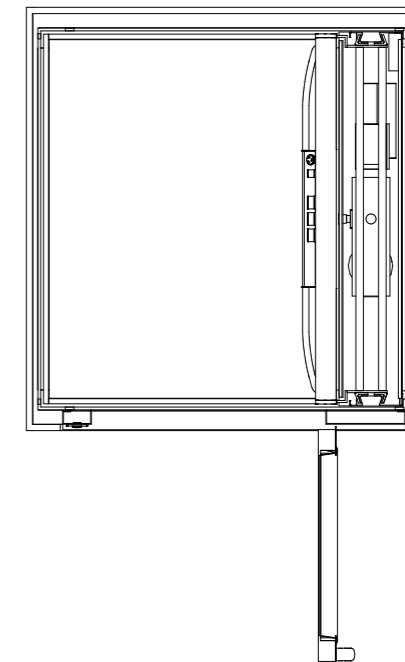

Skala: 1:30

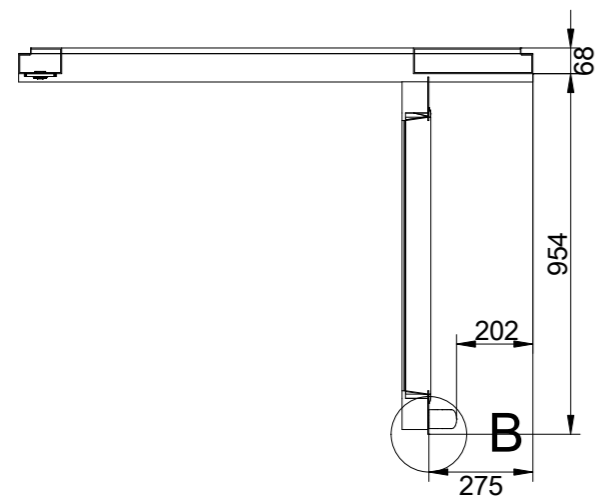

B

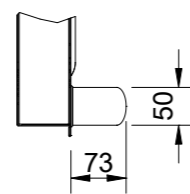

B (1:10)

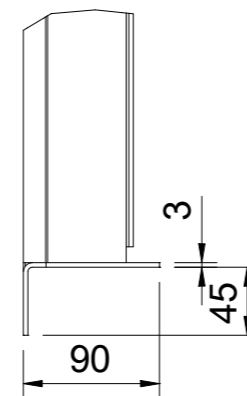

A (1:5)

Stannplan	Dörtyyp
0	A20
1	A20
2	A20

Godkänd av byggare:

European view placement:



Offert

Order

Gen. Tolerances
SS-ISO 27681-1 m

Principritning
A 5000 - 1100*1467
Landing information

Datum
2025-05-12
14:28

Blad
5 of 7

Skala:
A3, 1:60

Stannplan 2 och dörrfrontsinformation
Skala: 1:20

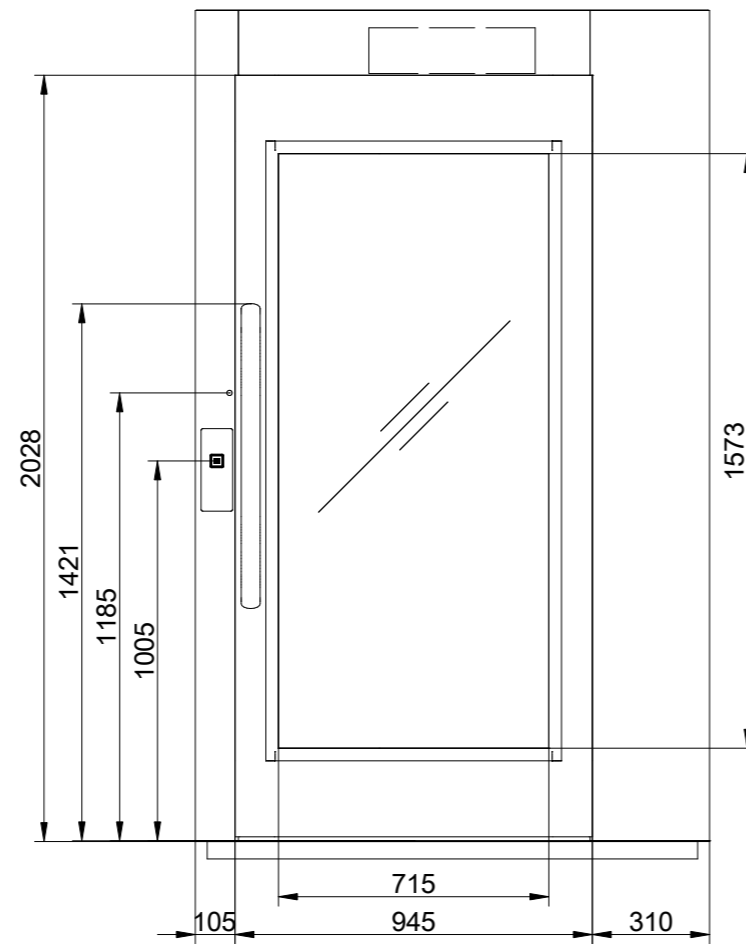
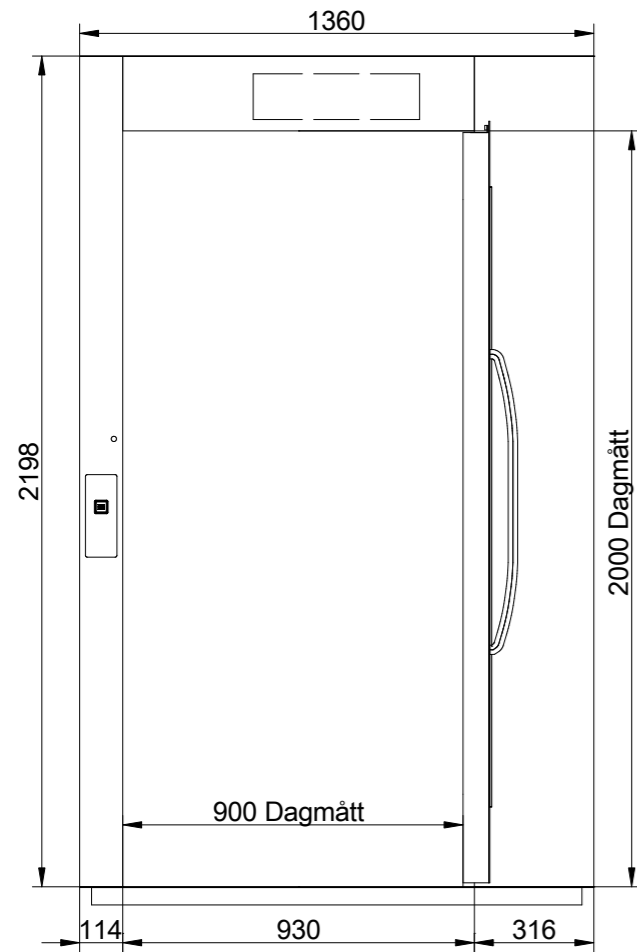

A

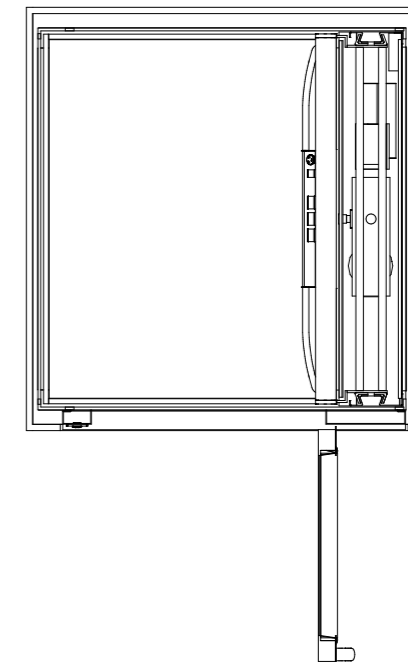

Skala: 1:30

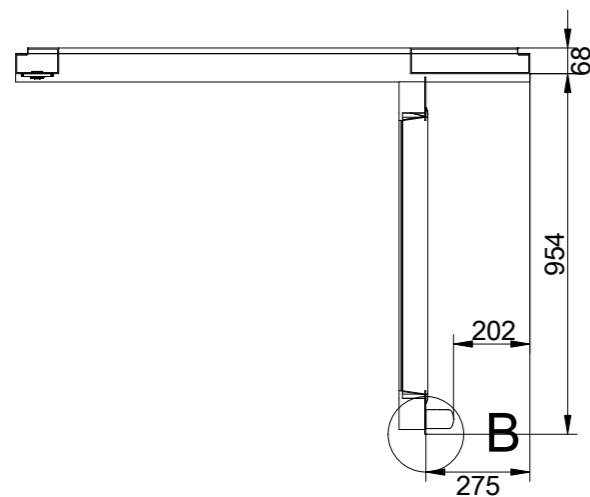

B

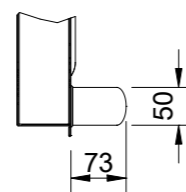

B (1:10)

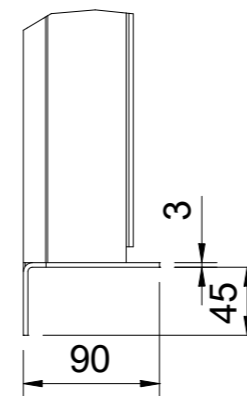

A (1:5)

Stannplan	Dörrtyp
0	A20
1	A20
2	A20

Godkänd av byggare:

European view placement:



Offert

Order

Gen. Tolerances
SS-ISO 27681-1 m

Principritning
A 5000 - 1100*1467
Landing information

Datum
2025-05-12
14:28

Blad
6 of 7

Skala:
A3, 1:60

6 5 4 3 2 1

Plattformslayout

Skala: 1:15

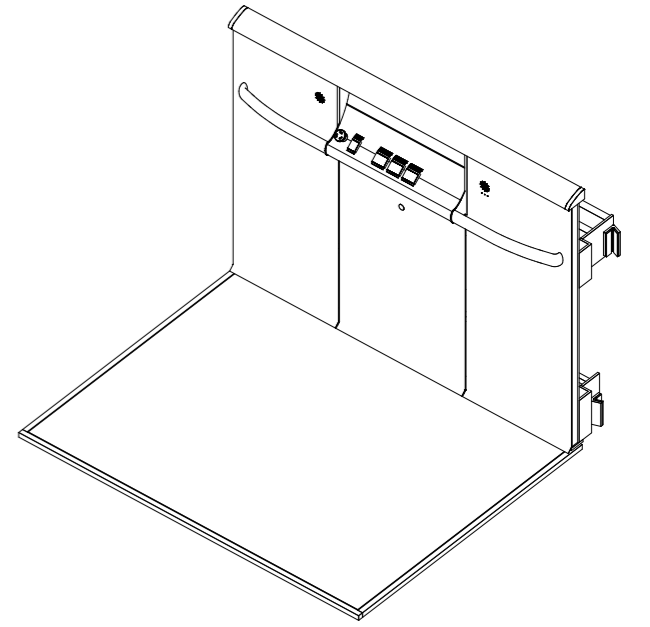
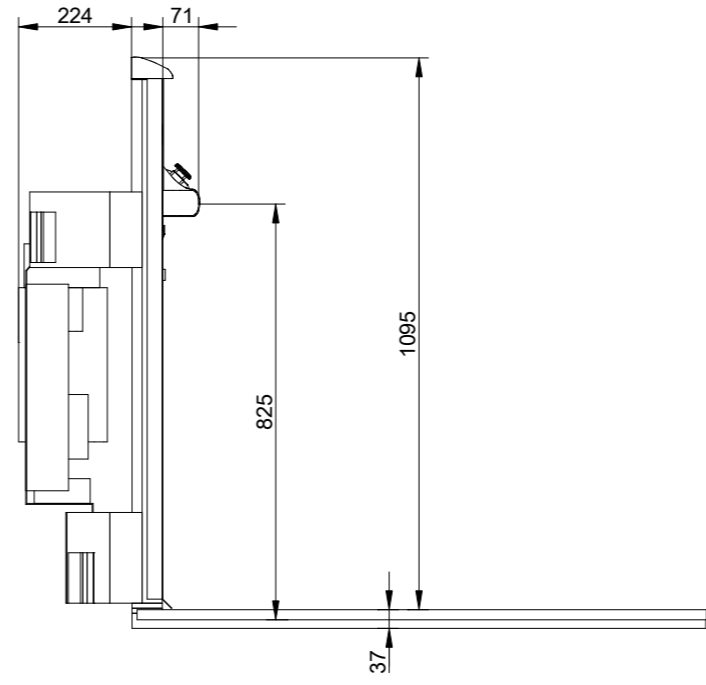
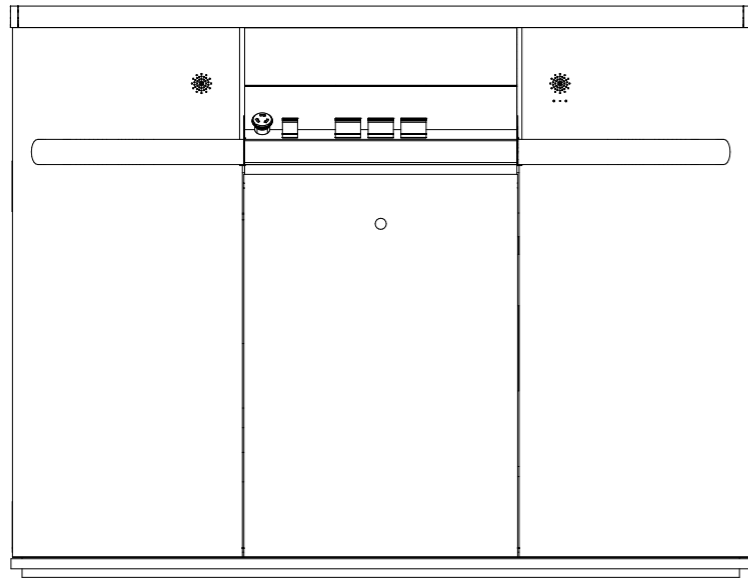

Plattformsdimensioner

Skala: 1:15

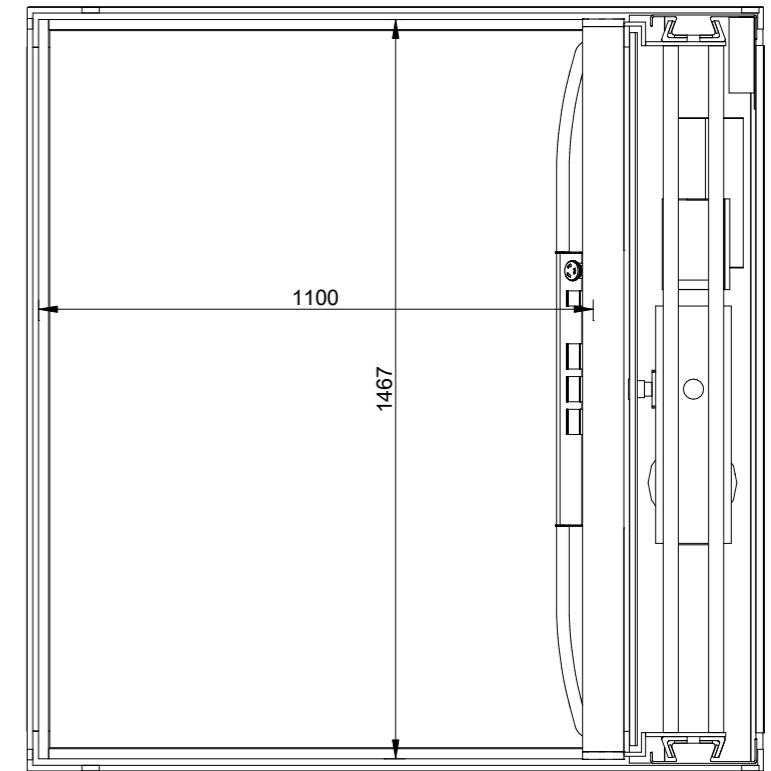

Knapplayout

Skala: 1:10

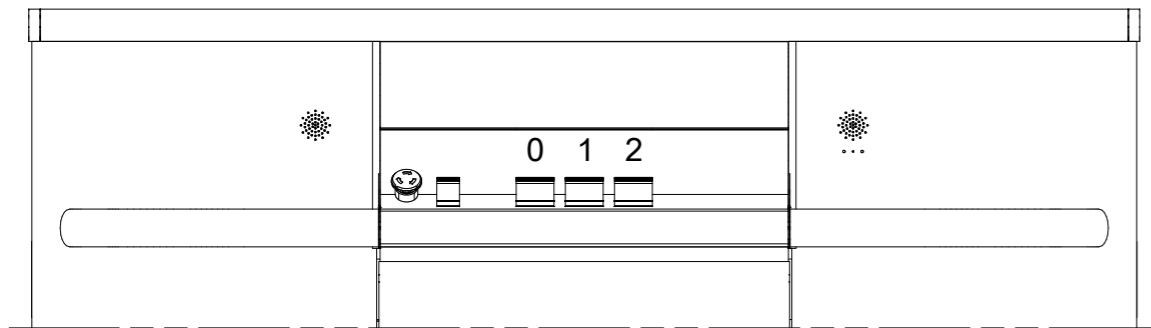

D

C

B

A

D

C

B

A

Godkänd av byggare:

European view placement:



Offert

Order

Gen. Tolerances
SS-ISO 27681-1 m

Principritning
A 5000 - 1100*1467
Platform layout

Datum
2025-05-12
14:28

Blad
7 of 7

Skala:
A3, 1:60

6 5 4 3 2 1