

# Symmetry Safety 3-Panel Door

Exclusively offered by Symmetry Elevating Solutions



Symmetry Safety 3-Panel Door with Clear vision panels

## Available with:

- Power car door operation
- Vision panels
- Multiple finish options

Proudly Made in the U.S.A.



# Symmetry Exclusive

The Symmetry Safety 3-Panel Door is one of the most reliable residential elevator car doors on the market. When coupled with the Flush Mount Door and/or Frame Package, our Safety 3-Panel Door creates a minimal amount of space between the elevator car door and landing door.

## Standard Features

- Manual Car Door Operation: The trailing panel of the car door measures 2 inches from edge of the car sill and is designed to fit within requirements of the  $\frac{3}{4}$ " x 4" rule, with maximum running clearance and maximum hoistway door set back of  $\frac{3}{4}$  inch
- Height of Opening: 7'0"
- Car Door Opening: 33 inches clear opening (fits in a "typical" hoistway with a 36 inch wide car)
- Standard Finish: Black

## Optional Features

- Light Curtain: Standard as secondary protective device if the unit is installed under ASME A17.1 (2013 and prior); optional if it is installed under ASME A17.1 (2016 and newer)
- Power Car Door Operation
- Height of Opening: 7'11"; custom heights available
- Car Door Opening: 36 inches clear opening (fits in a "typical" hoistway with a 40 inch wide car)
- Vision Panels: Available with Clear or Bronze acrylic
- Car Door: Available in Stainless Steel or powder-coated steel

*This brochure is intended for INFORMATIONAL PURPOSES ONLY and SHOULD NOT be used for construction.*

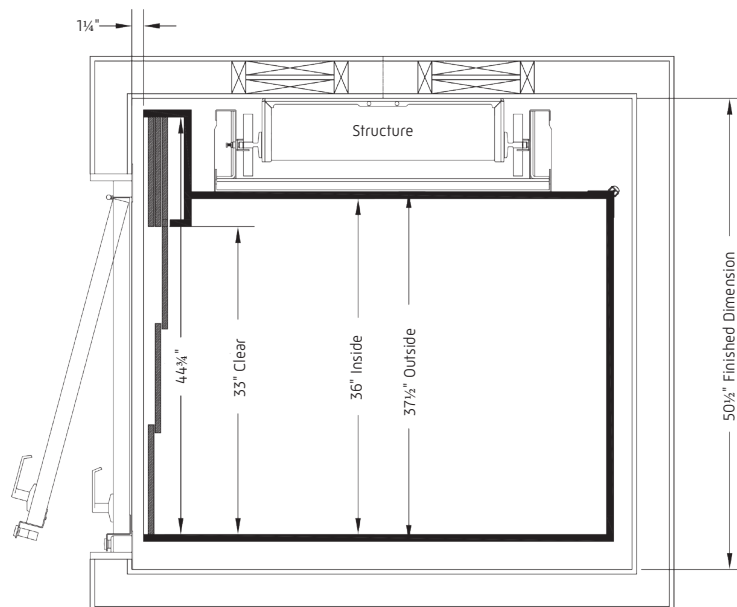

Shown with Symmetry Flush Mount Landing Door Package



Shown in Brushed Stainless Steel with Vision Panel

## Available Color Options

Full selection of RAL colors available.



Black  
standard



Brushed  
Stainless  
Steel



Ivory



Architectural  
White



Grey

## Available Acrylic Options



Clear



Bronze